

DO

- DO SEAL ALL CUTS
- DO APPLY HIGH QUALITY DECK OIL
- DO USE PROPER SPACING BETWEEN BOARDS BASED ON DIMENSION
- DO ALLOW MIN 16" ABOVE GRADE FOR PROPER VENTILATION
- DO PRE-DRILL ALL SCREW HOLES
- DO KEEP PILOT HOLES 3/4" AWAY FROM ENDS OF BOARDS
- DO USE HIGH QUALITY DECK SCREWS WITH SQUARE OR STAR DRIVE HEADS
- DO FOLLOW NUSKU THERMACOR INSTALLATION INSTRUCTIONS
- DO FOLLOW YOUR LOCAL BUILDING CODE REQUIREMENTS
- DO FOLLOW HIGHEST BUILDING INDUSTRY STANDARDS
- DO USE ONLY TOP QUALITY FINISHES & FOLLOW MANUFACTURER'S INSTRUCTIONS
- DO USE FINISHES THAT CONTAIN A WATER REPELLENT

DO NOT

- DO NOT USE INCORRECT SPACING BASED ON DIMENSION
- DO NOT USE LOW QUALITY SCREWS WITHOUT PROPER HOLDING POWER
- DO NOT INSTALL OR STORE IN CONTACT WITH THE GROUND
- DO NOT INSTALL WITH GAPS BETWEEN END BOARDS
- DO NOT STORE IN DIRECT CONTACT WITH CONCRETE
- DO NOT INSTALL WHERE WATER SPRINKLERS OR FOUNTAINS CAN REGULARLY WET
- DO NOT INSTALL WITHOUT MIN 16" ABOVE GRADE
- DO NOT FINISH OVER WET NUSKU THERMACOR PRODUCT
- DO NOT STORE WITH TIGHTLY WRAPPED PLASTIC
- DO NOT IGNORE QUICK START GUIDE
- DO NOT INSTALL THERMACOR LIGHT IN DECKING APPLICATIONS



"we harden homes"

READ ME
QUICK START GUIDE

FINISH THE PROJECT RIGHT



PROPER STORAGE



CORRECT HARDWARE

FAILURE TO FOLLOW PROPER INSTALLATION & FINISH PRACTICES WILL NEGATE PRODUCT WARRANTIES.

WOOD IS A PRODUCT OF NATURE, SO INDIVIDUAL PIECES VARY IN PERFORMANCE. DECKING, SIDING & EAVES ARE SINGULAR COMPONENTS OF A BUILDING. THE PERFORMANCE IS DEPENDENT ON MANY CRITICAL FACTORS INCLUDING THE STRUCTURE'S DESIGN, THE CRAFTSMEN'S SKILLS, THE USE OF OTHER MATERIAL, THE PRODUCTS EXPOSURE AND THE CLIMATE. THE MANUFACTURER AND MERCHANT HAVE NO CONTROL OVER THESE VARIABLES. FOLLOWING THIS MANUAL WILL HELP IN ACHIEVING SATISFACTORY PERFORMANCE UNDER MOST CONDITIONS; HOWEVER, IT WILL NOT GUARANTEE FLAWLESS PERFORMANCE. PLEASE REFER TO MANUFACTURER'S WARRANTY FOR ADDITIONAL INFORMATION.



SEAL ALL CUTS



TIME TO FINISH



STORAGE

STORE NUSKU THERMACOR IN A GARAGE OR SHED WITH ADEQUATE AIR CIRCULATION AND PROTECTION FROM THE ELEMENTS.

KEEP NUSKU THERMACOR DRY. IF IT CAN'T BE STORED UNDER A ROOF, PROTECT IT WITH A WATERPROOF COVER. MAKE SURE THE COVER IS SECURE BUT LOOSE ENOUGH TO PERMIT AIR CIRCULATION.

STORE NUSKU THERMACOR OFF THE GROUND, AWAY FROM WET CONCRETE AND PROTECTED FROM DIRT, MOISTURE, DIRECT SUN & EXTREME HEAT.

DEFINITELY AVOID



EXCESSIVE MOISTURE



EXCESSIVE SUN



EXCESSIVE HEAT



PROPER CIRCULATION



GROUND CLEARANCE



PROPER COVERAGE

DEFINITELY ALLOW

IF NUSKU THERMACOR IS EXPOSED TO EXCESSIVE HEAT OR SUN IT MAY SHRINK CAUSING CUPPING, CHECKING OR SAP BLEED. IF NUSKU THERMACOR IS EXPOSED TO EXCESSIVE MOISTURE IT CAN SWELL, RAISE GRAIN OR CAUSE CHECKING.



SHIPLAP SIDING

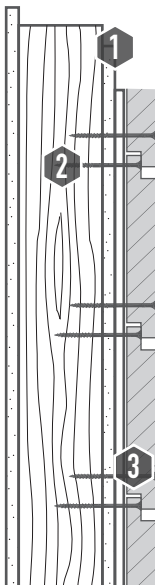

1 VAPOR BARRIER

APPLY A VAPOR BARRIER TO THE WALL. THEN ATTACH 3/4" FURRING STRIPS OVER THE VAPOR BARRIER EVERY 16".

2 PRE-DRILL & SCREW

START AT THE BOTTOM OF THE WALL & PRE-DRILL HOLES ABOVE EACH FURRING STRIP WITH 1/8" DRILL BIT. DRIVE A 3" STAINLESS STEEL SCREW THROUGH THE 1/8" PRE-DRILLED HOLE TO SECURE THE BOTTOM HALF OF EACH BOARD. THEN PRE-DRILL THROUGH THE LAP & DRIVE A 3" STAINLESS STEEL SCREW TO SECURE THE TOP HALF OF EACH BOARD. WHEN PROPERLY INSTALLED, THIS SCREW SHOULD BE COVERED BY THE FOLLOWING BOARD INSTALLED DIRECTLY ABOVE.

3 ALLOW SPACING

WHEN INSTALLING EACH BOARD, ALLOW 1/16" AVERAGE SPACING BETWEEN BOARDS TO ALLOW EXPANSION.

EXAMPLES OF DECKING & HORIZONTAL INSTALLATION

PRO TIP:
KEEP PILOT HOLES
3/4" FROM EACH
END TO PREVENT
SPLITTING

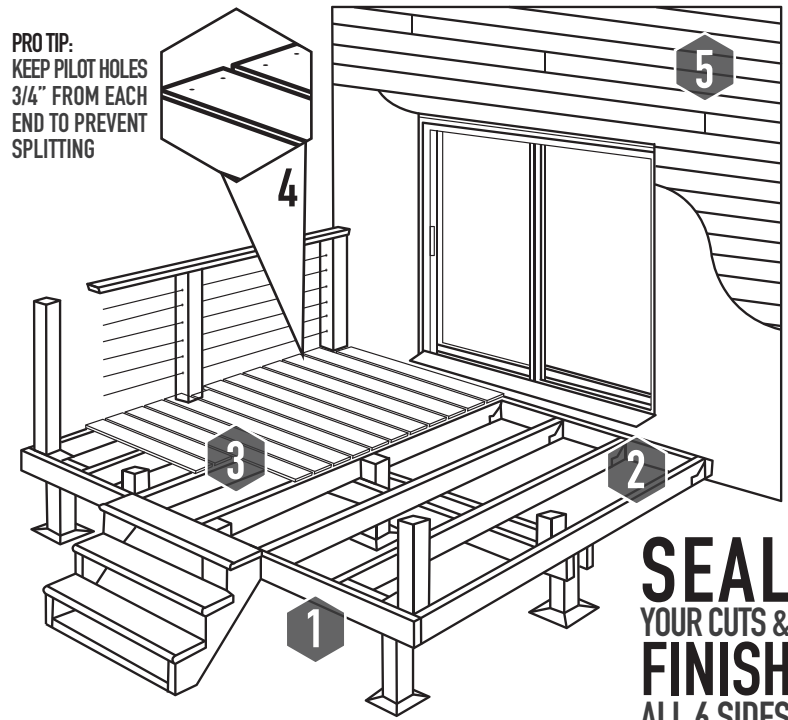

SEAL
YOUR CUTS &
FINISH
ALL 6 SIDES

1 VENTILATION

ALLOW FOR MIN 16" CLEARANCE BETWEEN UNDERSIDE OF DECKING & GROUND. ADEQUATE AIR CIRCULATION BENEATH THE DECK WILL HELP PREVENT CUPPING & WARPING. ADDITIONAL CLEARANCE IS RECOMMENDED IN WET AREAS.

2 SPAN

CONSULT LOCAL BUILDING CODES TO MEET COMPLIANCE WITH REGULATIONS. USUALLY 1X4 & 1X6 DECKING CAN BE INSTALLED 16" ON CENTER & 5/4 CAN BE INSTALLED 24" ON CENTER. ANGULAR INSTALLATION REQUIRES JOISTS AT 12" ON CENTER.

3 SPACING

INSTALL WITH 1/8" SPACING ON ALL 1X4 & 5/4X4, WHILE 1X6 & 5/4X6 USE 3/16" SPACING TO ALLOW FOR CIRCULATION & EXPANSION.

4 FASTENERS

TO PREVENT DISCOLORATION NEAR THE FASTENERS, STAINLESS STEEL SCREWS ARE RECOMMENDED AT A RATE OF TWO SCREWS PER JOIST. PRE-DRILLING IS REQUIRED AT ENDS OF BOARDS AND RECOMMENDED WHEN SCREWING THROUGH THE FACE. CONSULT DEALER FOR INFORMATION ON HIDDEN FASTENING SYSTEMS.

5 SIDING/RAINSCREEN

FOLLOW INSTRUCTIONS FROM HIDDEN FASTENER MANUFACTURER FOR RAINSCREEN & WHEN INSTALLING WITHOUT REFERENCE ALL DETAILS ABOVE FOR BEST PRACTICES.

*THERMACOR LIGHT IS NOT ALLOWED IN DECKING APPLICATIONS